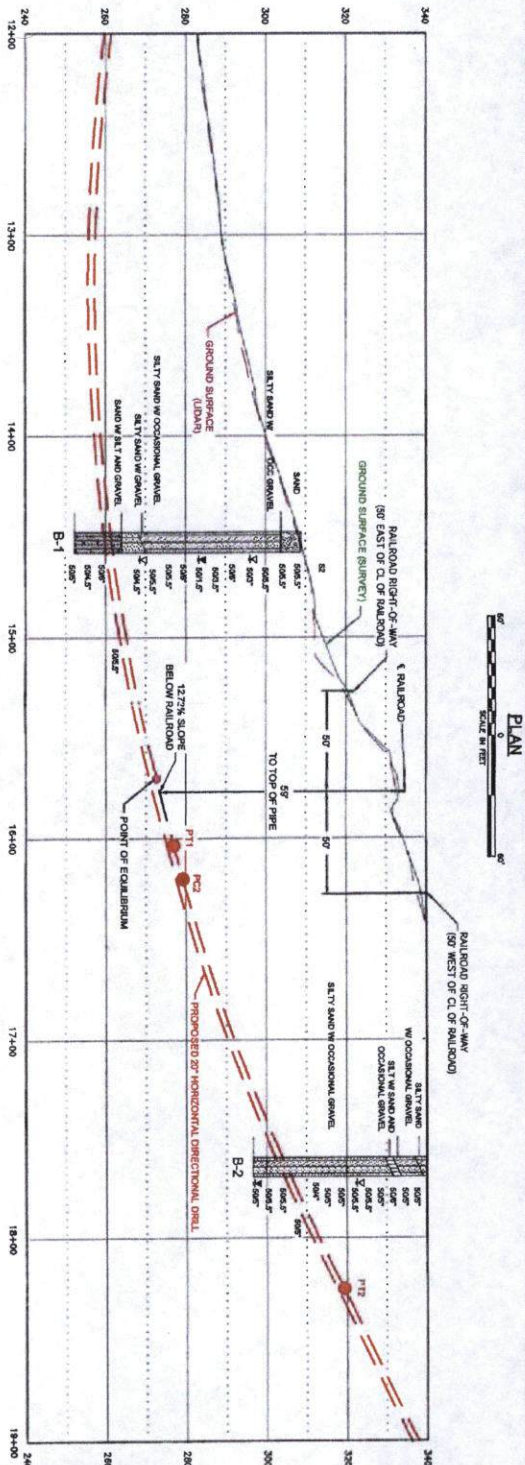

EXHIBIT A

Item No. 5c_Attach 2
Date of Meeting: June 26, 2012



- Notes:
1. Workspace limits are approximate, and should be confirmed with property plats prior to construction.
 2. The locations of all features shown are approximate.
 3. This drawing is for information purposes. It is intended to assist in showing features discussed in an attached document. GeoEngineers, Inc. can not guarantee the accuracy and content of electronic files. The master file is stored by GeoEngineers, Inc. and will serve as the official record of this communication.

Legend
 Boring Location

NOT FOR CONSTRUCTION
ISSUED FOR PERMIT ONLY

SITE PLAN	
NORTH SEATTLE LOOP HDD SNOHOMISH COUNTY, WASHINGTON	
GEOENGINEERS	FIGURE 2



Map of Proposed Easement Location

